

Defrost Timers

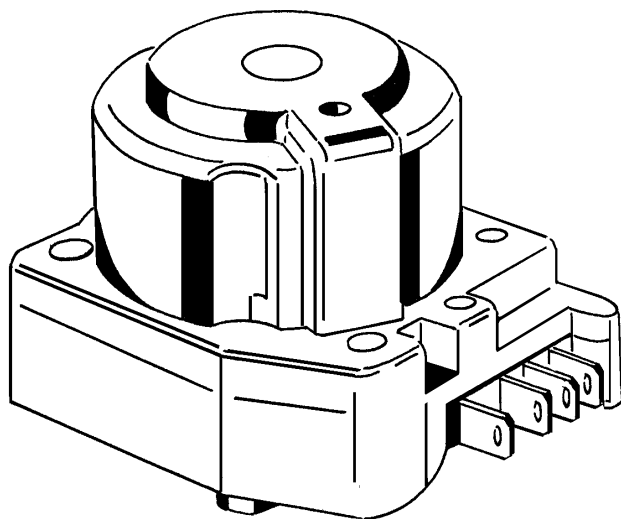

Invensys Defrost Timers are designed to control the defrost cycle of a refrigerator or a freezer. Their low cost features, together with long life reliability, meet virtually every refrigerator/freezer defrost time cycle requirement.

The synchronous motor and switch assembly inside the timer are protected against dust and dirt by a heat-resistant thermoplastic cover. The cover is ultrasonically welded to a phenolic case and affords excellent sound isolation.

An indicator on the Invensys Defrost Timer provides a visual means of checking whether the timer-motor is running. This together with the one-way clutch, makes for simple inspection and adjustment.

The ambient operating temperature range for these Defrost Timers is $-7^{\circ}\text{C}/+20^{\circ}\text{F}$ to $66^{\circ}\text{C}/150^{\circ}\text{F}$.

Specifications

Cycle Time:

Total cycle available with 4, 6, 8, 12 or 24 hour periods. Defrost period can be 7 to 108 minutes, depending on total cycle time.

Electrical Connections:

1/4" quick connect terminals - molded connector available.

Electrical Ratings:

Switch-15 amps,
1/2 HP125/250 VAC, 50-60 HZ
Motor-24 through 240 VAC,
50 or 60 HZ, rated at 3 watts

Gear Train:

Gears and cam are integrally molded celcon.

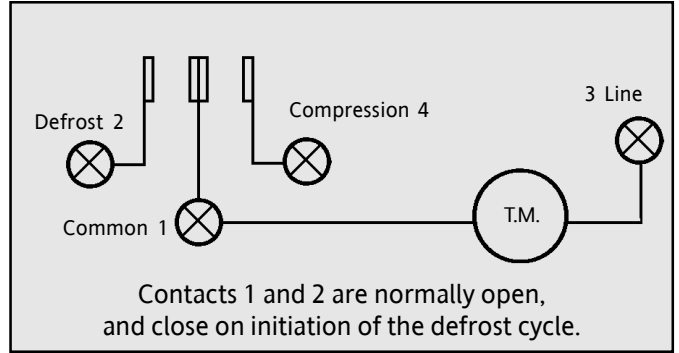

The above connections are typical.
Other connections are available.

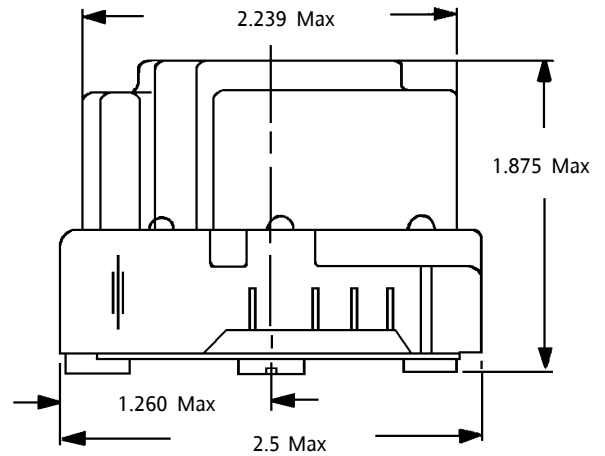
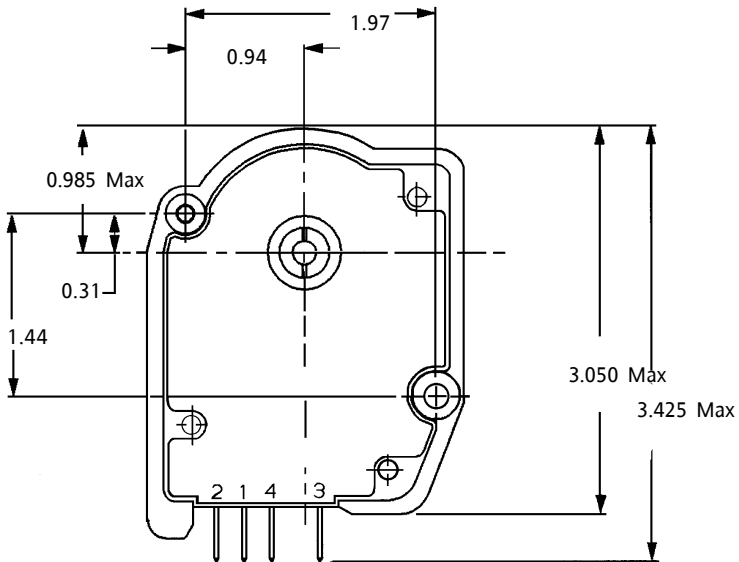

Information subject to change without notice.

7/99